



50 ~ 250 mg material sample
1,000 µL liquid sample



Elution Volume

100 ~ 130 µL

How to choose the appropriate Incubation Buffer

Incubation Buffer 1: General Buffer

Incubation Buffer 2: for leafy plant sample which contains high silicon or essential oil

Incubation Buffer 3: for plant tissue

Incubation Buffer 1/2

STEP 1 Pretreatment



Add 50 ~ 250 mg food or 50 ~ 100 mg plant tissue to the tube, then add 600 µL of either IB1 or IB2, followed by 10 µL of PK, and vortex thoroughly.

STEP 2 Incubation

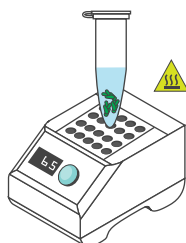

Incubate at 65°C for 30 min

Incubation Buffer 3

STEP 1 Pretreatment

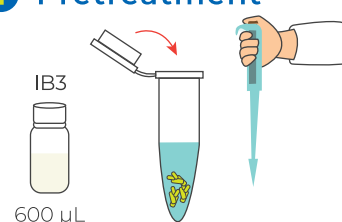

Add 50 ~ 100 mg of ground plant tissue and 600 µL IB3 to the tube

STEP 2 Vortex

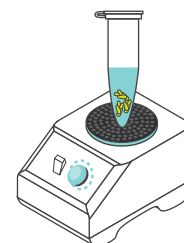

Vortex for thoroughly mixing

STEP 3 Centrifugation

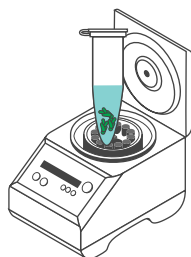

Centrifuge at 13,000 x g for 3 min

STEP 4 Extraction

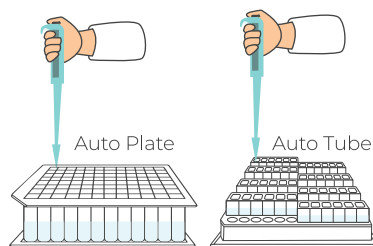

Transfer 600 µL of supernatant as the sample for the automatic process

STEP 5 Prepare to Run

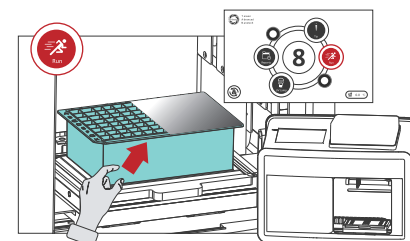

Place the extraction kit with cropped corner facing outwards. Tap **Run** icon. See back for Maelstrom Switch 8 Operation Quick Guide and start with **Step 8**.

※ Here is the illustration for CH 8 Gearbox with Auto Plate.

STEP 1 Install Gearbox

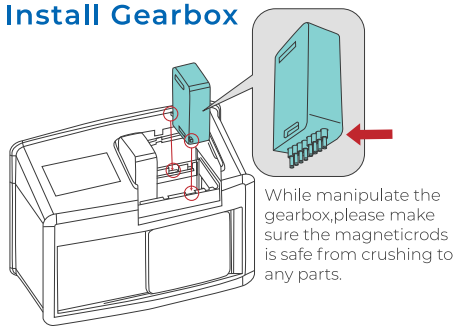

Power off. Open the top lid. Install one gearbox according to the sample type. Close the top lid.

STEP 2 Install Heating Plate

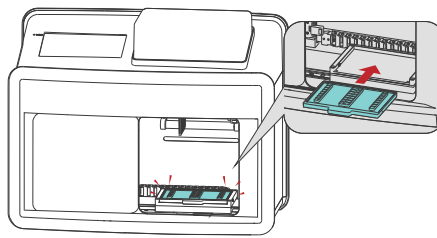

Open the door. Install the corresponding heating plate.

STEP 3 Power On

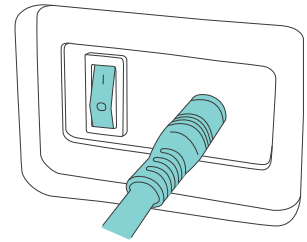

Power On the instrument.

STEP 4 Choose Rod Type and Login System

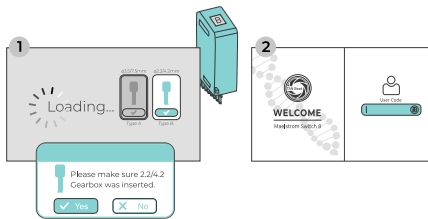

Select $\phi 2.2/4.2$ mm (TANBEAD reagent). Confirm "YES", then log in with user code "333" for operation.

STEP 5 Prepare to Run

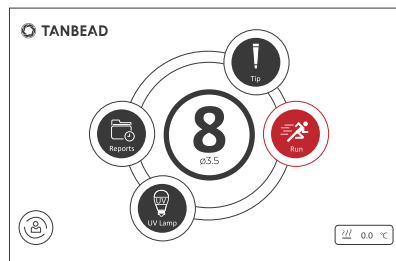

Tap first, double-tap the Program name from the OptiPure Blood DNA IFU, then follow the on-screen instructions.

STEP 6 Place the Spin Tips Assembled Box and Mounting Tips

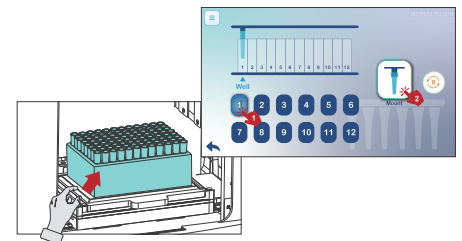

Place the spin tips assembled box onto the heating plate and insert the SW8, then tap the "mount" icon and confirm "YES" to start mounting.

STEP 7 Tip Box Removal

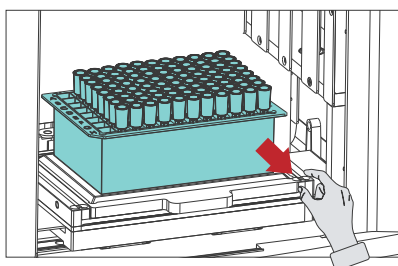

Remove the tip box after mount tips.

STEP 8 Start to Run

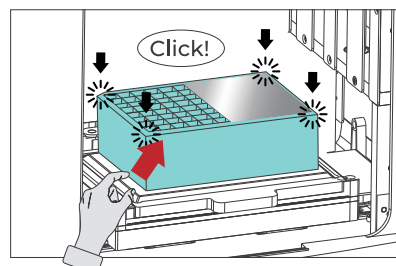

Install the reagent Plate (cut corner at bottom-left), press the four corners until it clicks, then press "YES" on the confirmation window to start the run.

STEP 9 Running Status

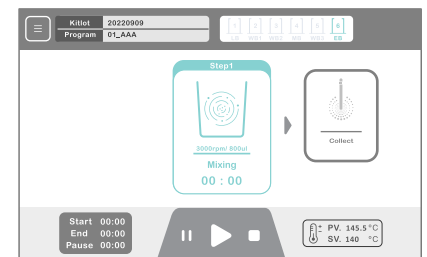

Check the display status. Tap on "||" to pause or "■" to stop and abort the run. When finished, "✔" icon will appear. Tap to enter the report and review the results. After reviewing the report, return to the previous page to perform tip ejection.

STEP 10 Extraction Complete

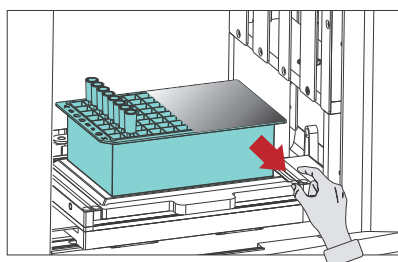

Remove extraction kit.

STEP 11 Transfer Nucleic Acids

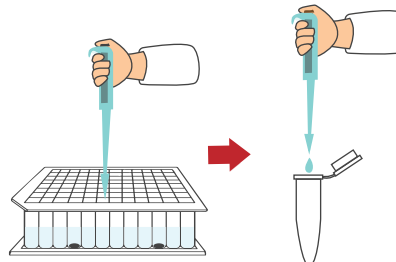

Transfer the purified nucleic acid from column #6/#12 to clean tube.



For more detailed information, please refer to the User manual within the following link.



Video How to Use



Video FAQ



User Manual

Taiwan Advanced Nanotech Inc. www.tanbead.com