

Fungi Nucleic Acid (63F) Quick Guide



TANBEAD



Starting Materials

Cultured fungal samples



Elution Volume

40 ~ 90 μ L

Liquid Sample

STEP 1 Centrifugation

Centrifuge
6000xg, 4min



Sterilized Glass Beads Tube with 1 O.D. liquid sample broth.

STEP 2 Discard Supernatant

IB.



600 μ L

Discard supernatant.
Add 600 μ L IB.

STEP 3 Homogenization

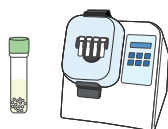

Grind the sample by bead homogenizer equipment.
maximum speed for \geq 5 min

STEP 4 Lysis

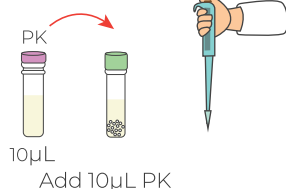

10 μ L

Add 10 μ L PK

STEP 5 Incubation



Incubate at 56 $^{\circ}$ C for 30 min.

STEP 6 Centrifugation



Centrifuge 10000xg, 1min

STEP 7 Loading Samples

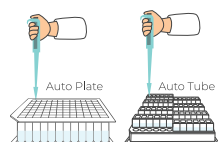

Add 600 μ L supernatant, then
initiate the automatic process.

Solid Culture Sample

STEP 1 Pretreatment

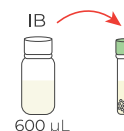

600 μ L

Add 50~100 mg (wet weight) solid culture sample
into Sterilized Glass Beads Tube.
Add 600 μ L Incubation Buffer into glass-bead tube.

STEP 2 Homogenization

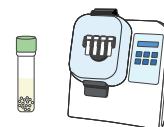

Grind the sample by bead homogenizer equipment
maximum speed for \geq 5 min

STEP 3 Lysis

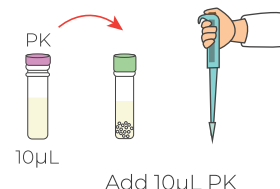

10 μ L

Add 10 μ L PK

STEP 4 Incubation



Incubate at 56 $^{\circ}$ C for 30 min.

STEP 5 Centrifugation



Centrifuge 10000xg, 1min

STEP 6 Loading Samples

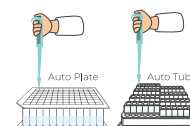

Add 600 μ L supernatant, then
initiate the automatic process.

※ Here is the illustration for CH 8 Gearbox with Auto Plate.

STEP 1 Install Gearbox

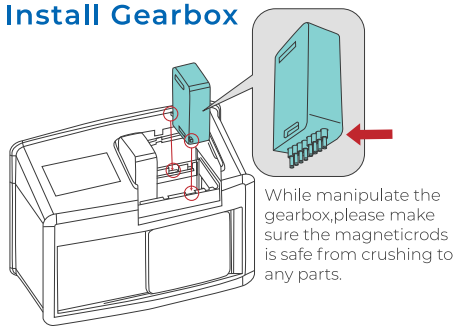

While manipulate the gearbox, please make sure the magnetic rods is safe from crushing to any parts.

Power off. Open the top lid. Install one gearbox according to the sample type. Close the top lid.

STEP 4 Choose Rod Type and Login System

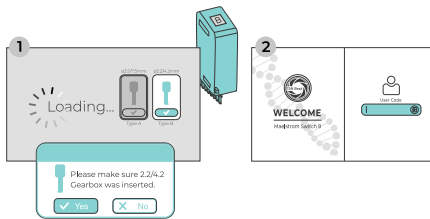

Select $\phi 2.2/4.2$ mm (TANBEAD reagent). Confirm "YES", then log in with user code "333" for operation.

STEP 7 Tip Box Removal

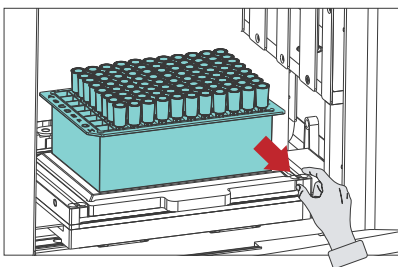

Remove the tip box after mount tips.

STEP 10 Extraction Complete

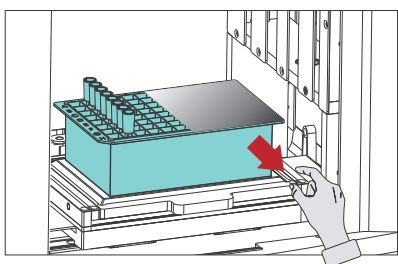

Remove extraction kit.

STEP 2 Install Heating Plate

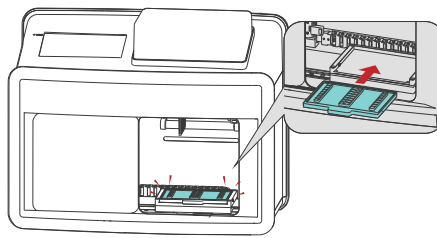

Open the door. Install the corresponding heating plate.

STEP 5 Prepare to Run

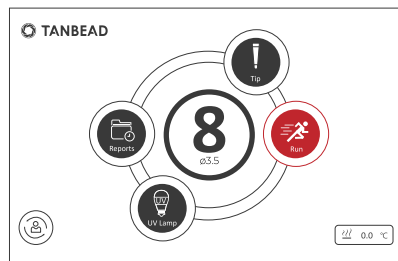

Tap first, double-tap the Program name from the OptiPure Blood DNA IFU, then follow the on-screen instructions.

STEP 8 Start to Run

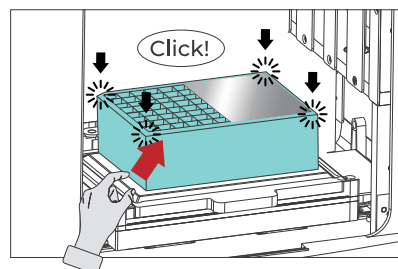

Install the reagent Plate (cut corner at bottom-left), press the four corners until it clicks, then press "YES" on the confirmation window to start the run.

STEP 11 Transfer Nucleic Acids

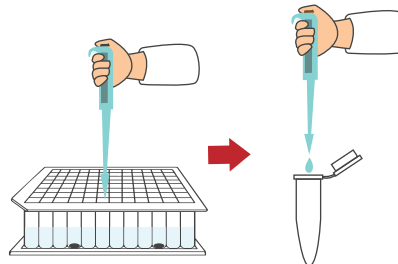

Transfer the purified nucleic acid from column #6 / #12 to clean tube.

STEP 3 Power On

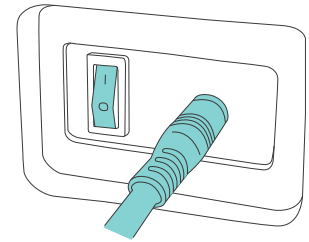

Power On the instrument.

STEP 6 Place the Spin Tips Assembled Box and Mounting Tips

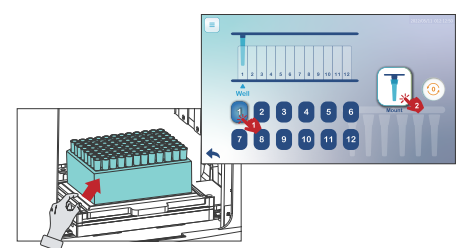

Place the spin tips assembled box onto the heating plate and insert the SW8, then tap the "mount" icon and confirm "YES" to start mounting.

STEP 9 Running Status

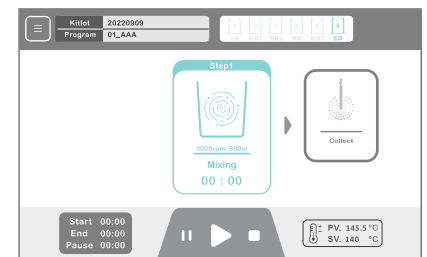

Check the display status. Tap on "||" to pause or "■" to stop and abort the run. When finished, "✓" icon will appear. Tap to enter the report and review the results. After reviewing the report, return to the previous page to perform tip ejection.



Maelstrom Switch 8

For more detailed information, please refer to the User manual within the following link.



Video
How to Use



Video
FAQ



User Manual

Taiwan Advanced Nanotech Inc. www.tanbead.com