

FFPE RNA (62P) Quick Guide

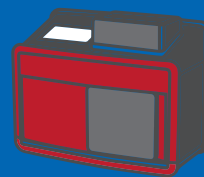

TANBEAD



Starting Materials
FFPE section or curl input
~ 25 mm² tissue size: 4~8
pieces of 5 μm FFPE section



≥70 μL

Elution Volume

STEP 1 Pretreatment

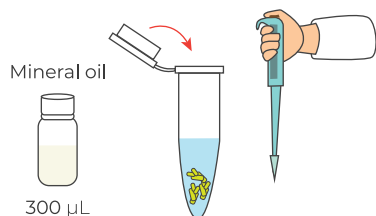

Put FFPE tissue sections into a clean 1.5 mL tube. Add 300 μL Mineral oil.

STEP 2 Vortex

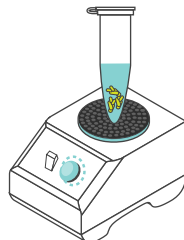

Vortex for thoroughly mixing

STEP 3 Incubation

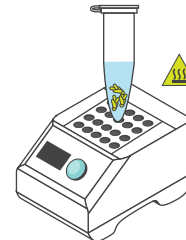

Incubate at 80°C for 5 min

STEP 4 Lysis

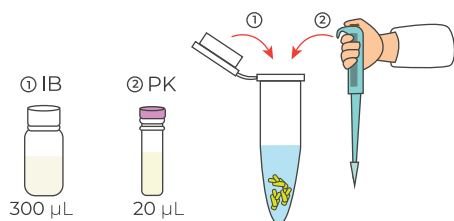

Add 300 μL Incubation Buffer and 20 μL PK

STEP 5 Centrifugation



Centrifuge at 10,000 x g for 1 min

STEP 6 Mix

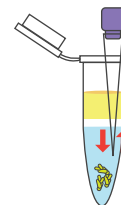

Gently mix with a micropipette to resuspend the tissue residues in the lower layer without disrupting the upper layer.

STEP 7 Incubation

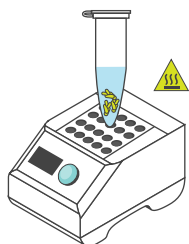

Incubate at 56°C for 1 ~ 2.5 hr, then incubate at 80°C for 15 min

STEP 8 Centrifugation

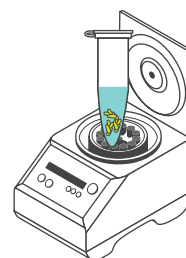

Centrifuge at 10,000 x g for 3 min

STEP 9 Extraction

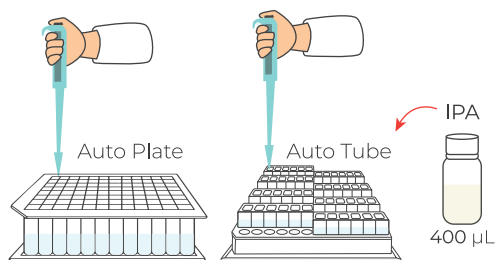

Add 400 μL Isopropanol and transfer 200 μL of collect the colorless lower aqueous phase as the sample for the following automatic process.

STEP 10 Prepare to Run

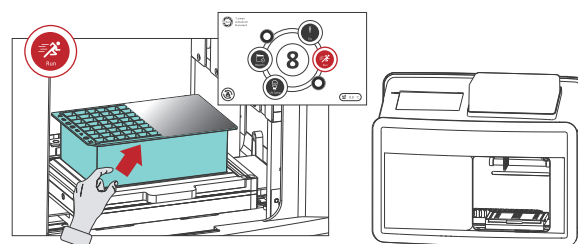

Place the extraction kit with cropped corner facing outwards. Tap **Run** icon. See back for Maelstrom Switch 8 Operation Quick Guide and start with **Step 8**.

※ Here is the illustration for CH 8 Gearbox with Auto Plate.

STEP 1 Install Gearbox

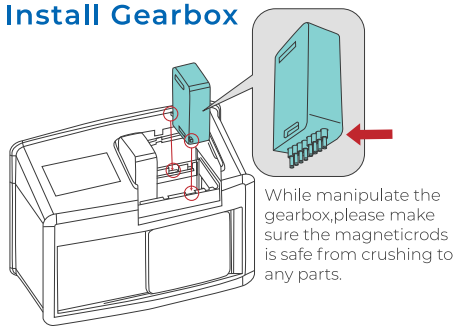

Power off. Open the top lid. Install one gearbox according to the sample type. Close the top lid.

STEP 2 Install Heating Plate

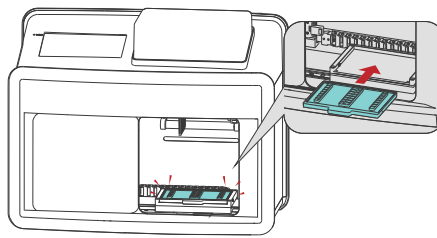

Open the door. Install the corresponding heating plate.

STEP 3 Power On

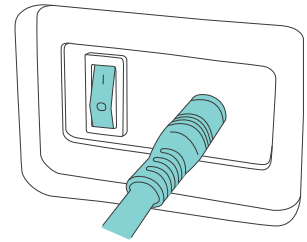

Power On the instrument.

STEP 4 Choose Rod Type and Login System

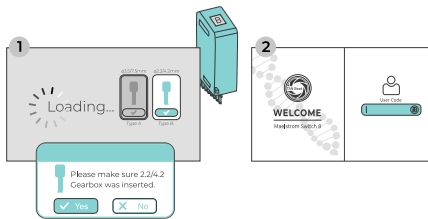

Select $\phi 2.2/4.2$ mm (TANBEAD reagent). Confirm "YES", then log in with user code "333" for operation.

STEP 5 Prepare to Run

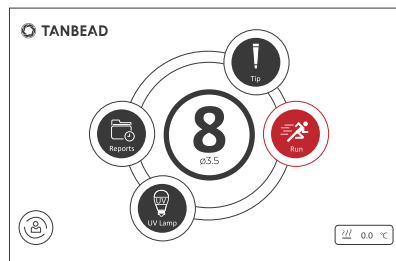

Tap first, double-tap the Program name from the OptiPure Blood DNA IFU, then follow the on-screen instructions.

STEP 6 Place the Spin Tips Assembled Box and Mounting Tips

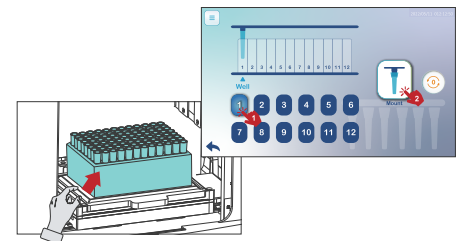

Place the spin tips assembled box onto the heating plate and insert the SW8, then tap the "mount" icon and confirm "YES" to start mounting.

STEP 7 Tip Box Removal

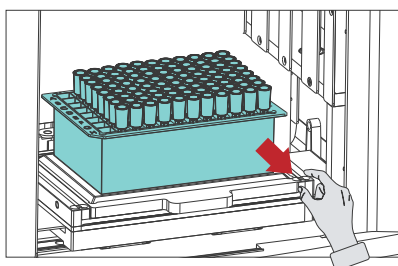

Remove the tip box after mount tips.

STEP 8 Start to Run

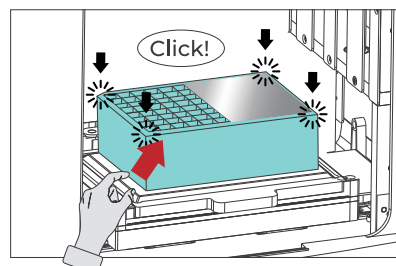

Install the reagent Plate (cut corner at bottom-left), press the four corners until it clicks, then press "YES" on the confirmation window to start the run.

STEP 9 Running Status

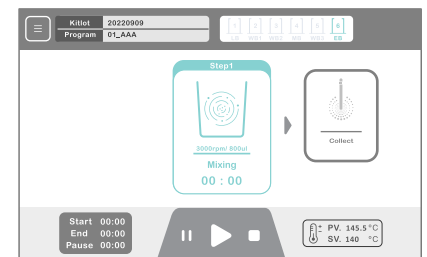

Check the display status. Tap on "||" to pause or "■" to stop and abort the run. When finished, "✔" icon will appear. Tap to enter the report and review the results. After reviewing the report, return to the previous page to perform tip ejection.

STEP 10 Extraction Complete

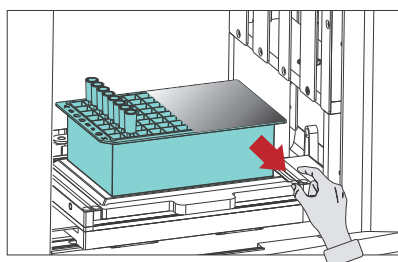

Remove extraction kit.

STEP 11 Transfer Nucleic Acids

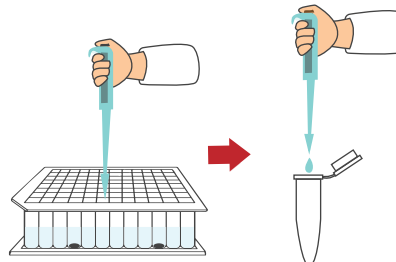

Transfer the purified nucleic acid from column #6/#12 to clean tube.



For more detailed information, please refer to the User manual within the following link.



Video How to Use



Video FAQ



User Manual

Taiwan Advanced Nanotech Inc. www.tanbead.com